

LAY LECTERN PARTS ON FLAT, PROTECTED SURFACE FOR ASSEMBLY. STORE KNOBS IN BASE FOR SAFEKEEPING.



TABLETOP LECTERN  
MODEL #118

① REMOVE KNOBS AND OPEN SIDES

② PLACE TOP PANEL UP-SIDE DOWN

③ FLIP BASE OVER ONTO TOP PANEL

④ ALIGN AND ATTACH  
BASE TO TOP  
- NOTE FRONT

⑤ INSTALL KNOBS  
THRU HINGES  
INTO TOP DO NOT  
OVER-TIGHTEN

⑥ TURN OVER  
TO USE

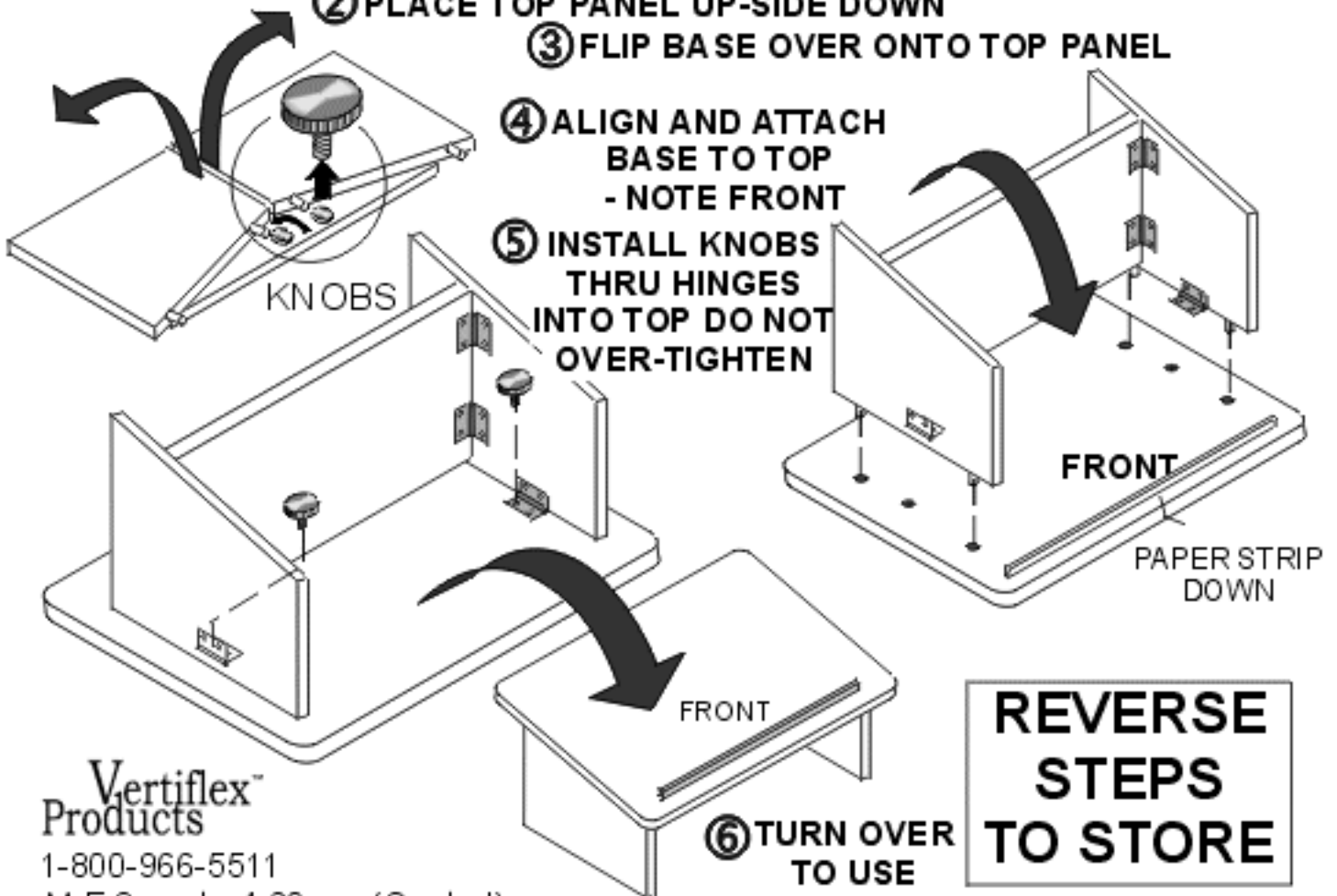

Vertiflex™  
Products

1-800-966-5511

M-F 8am. to 4:30pm. (Central)

REVERSE  
STEPS  
TO STORE